



ViperRay

USER MANUAL

SCRAPPER COMPACT LASER SIGHT

CONTENTS

KEY FEATURES	3
QUICK START & DIAGRAM	4
SPECIFICATION	5
DELIVERY SETS	5
MOUNTING	6
ZEROING & INSTALLATION PRESSURE SWITCH	7
BATTERY EXCHANGE & MAINTENANCE	8
STORAGE & SAFETY & WARNING	9
WARRANTY	10



*NEVER LOOK AT THE LASER SIGHT IT MAY PERMANENTLY DAMAGE YOUR EYES.
MAKE SURE FIREARMS ARE UNLOADED AND POINTED IN THE SAFE DIRECTION.*

KEY FEATURES

1. Infrared laser and visible laser combo.
2. Great shockproof, IPX4 water resistant.
3. On/Off or Mouse tail control switch.
4. Robust design with picatinny rail mount.
5. Tool-free laser adjustments.

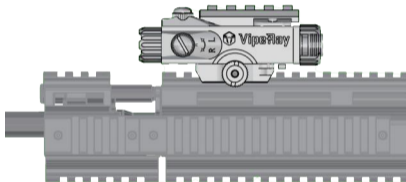

QUICK START & DIAGRAM

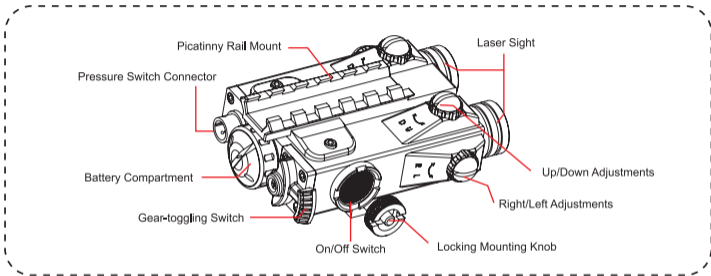

- Simply click the On/Off switch to turn the laser on or off.
- The laser has three modes: visible Laser, IR Laser, visible laser and IR laser combo.
- Operate the gear-toggling switch for mode selection.

SPECIFICATION

Laser Wavelength	IR Laser Combo GenII		IR Laser Combo GenII	
	Red Laser	IR Laser		Green Laser
	635-660 nm	830-850 nm		510-532 nm
Housing Material	Aluminum alloy 6061-T6			
Dimension	≤97x74x48mm (3.8x2.9x1.9in)			
Net Weight	255g (9oz)			
Battery Type	CR123A(2pcs) 3V 1300mAH			
Runtime	28 Hours	24 Hours		17.5 Hours
Runtime (Combo)	13 Hours		11 Hours	
Working Mode	Visible Laser, IR Laser, Visible +IR laser			
Working Temperature	-20 to 50°C (-4 to 113°F)			

DELIVERY SETS

Laser Sight

Wrench

Pressure Switch

User Manual

Packing Box

MOUNTING

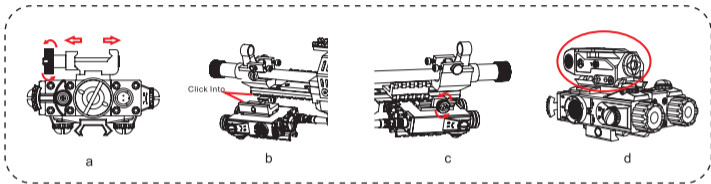

- Loosen the locking mounting knob, and open the picatinny rail card slot.
- Place the laser sight toward the muzzle. Set the laser sight flat on the bottom of the rail base. Align the guide rail with the picatinny rail card slot, and click the device into the guide rail.
- Adjust the mounting knob.
- The picture shows how the sight takes its own rails equipped with other devices.

WARNING: After first checking insure that weapon is unloaded and has no ammunition in the chamber.

ZEROING

The sight features elevation and windage adjustments. The elevation is the vertical (up and down) adjustment, usually on the top of the sight. Windage is the horizontal (left-to-right) adjustment, usually on the left and right sides.

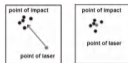

With the sight mounted, rest the firearm onto a solid support and aim at a target 30 yards away. Slowly shoot a small 3 to 5-round test group onto your target. Adjust windage & elevation screws in the direction you want to move the bullet impact. Shoot another 3 to 5-round test group. Repeat until you are satisfied with the point of aim.

INSTALLATION PRESSURE SWITCH

Pull up part A, zero in the groove joint at the connector. When removing the pressure switch, pull up at part A.

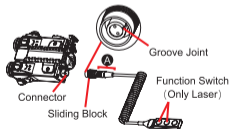

BATTERY EXCHANGE

Your Laser is powered by 2 pcs of CR123A battery. To insert, remove or replace the battery: Unscrew the battery cover at the rear, insert the battery in the right direction of the battery compartment, and tighten the battery compartment.

Caution: Should the laser grows dim or not turn on, you will need to exchange the battery.

SEALED AND WATER-RESISTANT

The unit has an O-ring to prevent the entry of dust or moisture or rain.

MAINTENANCE

Your laser sight, though amazingly tough, is a precision instrument that deserves reasonable cautious care.

When cleaning the sight, first blow away any dirt and dust, or use a soft lens brush. Fingerprints and lubricants can be wiped off with lens tissue, or soft clean cotton cloth, moistened with lens cleaning fluid.

All moving parts of the scope are permanently lubricated. Do not try to lubricate them.

No maintenance is needed on the sight outer surface, except to occasionally wipe off dirt or fingerprints with a soft cloth.



STORAGE

Avoid storing the laser in hot places, such as the passenger compartments of vehicles on hot days. The high temperatures could adversely affect the lubricants and sealants. A vehicle's trunk, a gun cabinet, or a closet is preferable.

For more information please visit our website: www.viperay.com

SAFETY & WARNING

- Direct viewing of the laser is hazardous to the eyes.
- Never look directly into the laser beam.
- Never point a laser at the person.
- Do not allow children to use laser unless under adult supervision.



THREE YEARS LIMITED WARRANTY

Your VipeRay product is warranted free of defects in materials and workmanship for a period of 3 years from the time of purchase by the original purchaser. This warranty covers accidental damage, as well as any defects in materials and workmanship. Batteries, damages caused by misuse or improper handling are not covered. In the event of a defect under this warranty, we promise to repair or replace your product and ship it back to you absolutely free of charge. Also, this warranty is null and void if modification or maintenance is provided by someone other than VipeRay. This warranty is non-transferable.

For products not directly purchased from us, please contact the local dealer for an applicable warranty.

For more details please visit our website, thanks for your support.

WWW.VIPERAY.COM



NOTES

HIT OR NOT, EACH SHOT TOLD



WWW.VIPERAY.COM